



STANDARD CONSTRUCTION

MATERIAL:
28 GAUGE ASTM A-653 HOT-DIPPED GALVANIZED
STEEL SHEET

STANDARD SIZES:

MODEL	INSIDE DIA.	OUTSIDE DIA.	BOX QTY.
CR4	4"	6"	100
CR5	5"	7"	100
CR6	6"	8"	100
CR7	7"	9"	100
CR8	8"	10"	100
CR10	10"	12"	100
CR12	12"	14"	100
CR14	14"	16"	100
CR16	16"	18"	100
CR18	18"	20"	100

FEATURES

28 GAUGE GALVANIZED STEEL PROVIDES EXCELLENT
CORROSION RESISTANCE AND LONGEVITY.

SOLD IN BOX QUANTITIES OF 100 PIECES.

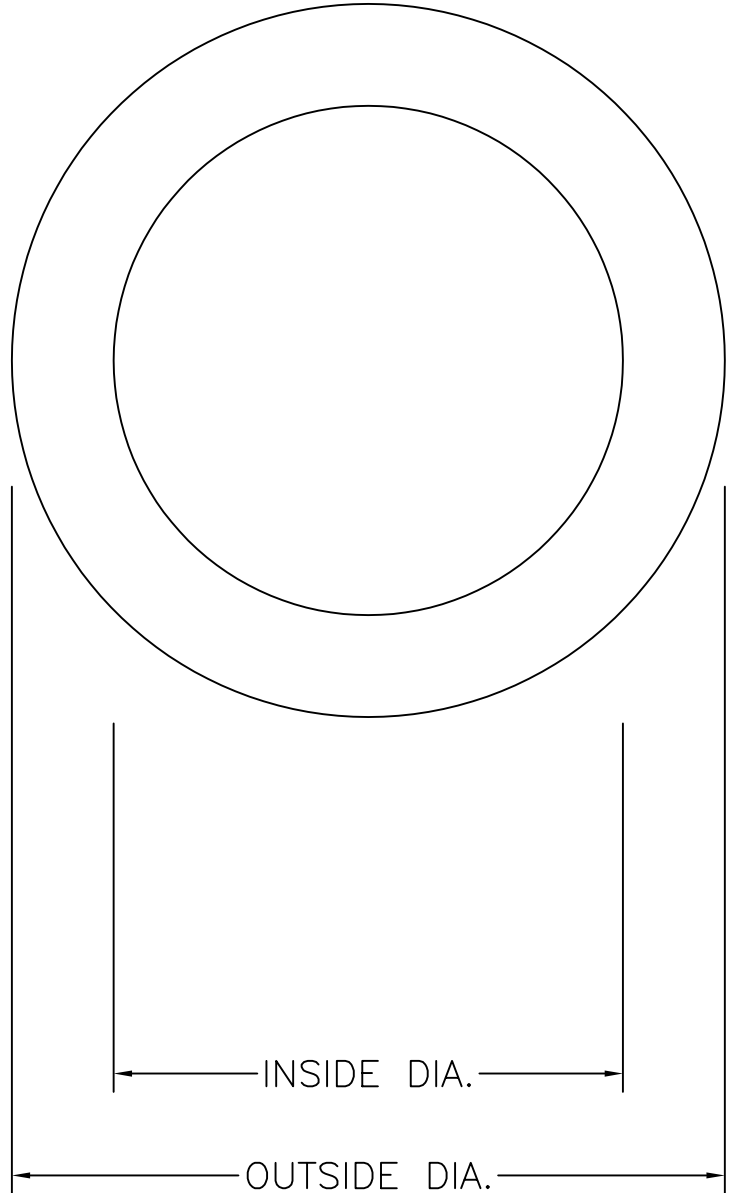

JOB NAME:
LOCATION:
ARCHITECT:
ENGINEER:
CONTRACTOR:
CONTACT MIAMI TECH INC. FOR ADDITIONAL INFORMATION OR WITH SPECIAL REQUIREMENTS. 3611 NW 74TH ST MIAMI, FL 33147 PHONE: 305-693-7054 FAX: 305-693-6152 WEB: WWW.MIAMITECH.COM EMAIL: SALES@MIAMITECH.COM

CR
C-RING
PRODUCT SPECIFICATIONS

NOTE: ALL DRAWINGS SUBJECT TO CHANGE WITHOUT PRIOR NOTICE.



DRAWN BY: AF	DATE: 10/12/07	SCALE: NOT TO SCALE	DRAWING NO.:
CHECKED BY: IG	DATE: 10/12/07	REVISION: 1	CR